



Nuova C.U.M.E.T.
Milling Tool Holder

Precision in *movement!*

TESTINA PER COPIATURA

Threaded Milling Cutters for Copying

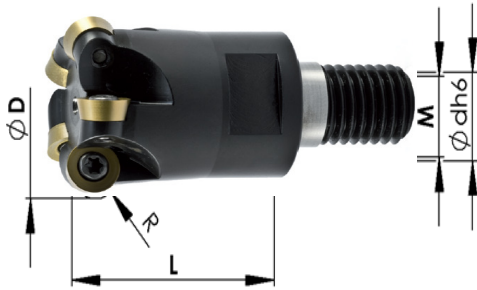

CON REFRIGERAZIONE INTERNA - WITH INTERNAL COOLANT

| CODE | D mm | L mm | M ISO | d mm | R mm | Z No | Insert | Vite Screw | Torx Key |
|------------|------|------|-------|------|------|------|----------|------------|----------|
| TRD0120602 | 12 | 18 | 6 | 6.5 | 3.5 | 2 | RD..0701 | A25 | T07 |
| TRD0150802 | 15 | 23 | 8 | 8.5 | 3.5 | 2 | RD..0702 | | |
| TRD0160802 | 16 | 23 | 8 | 8.5 | 3.5 | 2 | | | |
| TRD0160803 | 16 | 23 | 8 | 8.5 | 3.5 | 3 | | | |
| TRD0201003 | 20 | 30 | 10 | 10.5 | 3.5 | 3 | | | |
| TRD0201004 | 20 | 30 | 10 | 10.5 | 3.5 | 4 | | | |
| TRD0251205 | 25 | 35 | 12 | 12.5 | 3.5 | 5 | | | |
| TRD0321605 | 32 | 43 | 16 | 17 | 3.5 | 5 | | | |
| TRD0201002 | 20 | 30 | 10 | 10.5 | 5 | 2 | RD..1003 | A35 | T15 |
| TRD0251202 | 25 | 35 | 12 | 12.5 | 5 | 2 | | | |
| TRD0251203 | 25 | 35 | 12 | 12.5 | 5 | 3 | | | |
| TRD0321603 | 32 | 43 | 16 | 17 | 5 | 3 | | | |
| TRD0321604 | 32 | 43 | 16 | 17 | 5 | 4 | | | |
| TRD0351603 | 35 | 43 | 16 | 17 | 5 | 3 | | | |
| TRD0351604 | 35 | 43 | 16 | 17 | 5 | 4 | | | |
| TRD0351605 | 35 | 43 | 16 | 17 | 5 | 5 | | | |
| TRD0401604 | 40 | 43 | 16 | 17 | 5 | 4 | | | |
| TRD0421605 | 42 | 43 | 16 | 17 | 5 | 5 | | | |

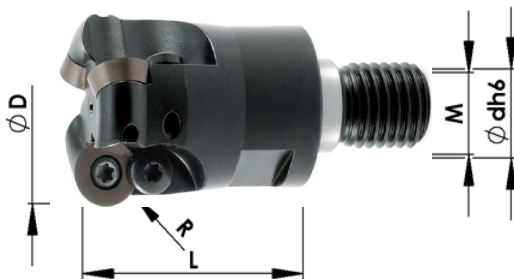

CON REFRIGERAZIONE INTERNA - WITH INTERNAL COOLANT

| CODE | D mm | L mm | M ISO | d mm | R mm | Z No | Insert | Vite Screw | Vite Fissaggio Securing Screw | Torx Key |
|-------------|------|------|-------|------|------|------|----------|------------|-------------------------------|----------|
| TRD12241202 | 24 | 35 | 12 | 12.5 | 6 | 2 | RD..12T3 | A38M | - | T15 |
| TRD12251202 | 25 | 35 | 12 | 12.5 | 6 | 2 | | | | |
| TRD12321603 | 32 | 43 | 16 | 17 | 6 | 3 | | | | |
| TRD12351603 | 35 | 43 | 16 | 17 | 6 | 3 | | | | |
| TRD12401604 | 40 | 43 | 16 | 17 | 6 | 4 | | | | |
| TRD12421604 | 42 | 43 | 16 | 17 | 6 | 4 | | | | |

TESTINA PER COPIATURA

Threaded Milling Cutters for Copying

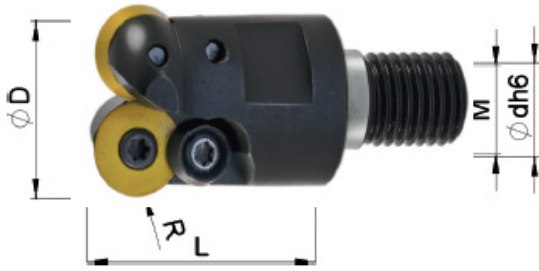

CON REFRIGERAZIONE INTERNA - WITH INTERNAL COOLANT

| CODE | D mm | L mm | M ISO | d mm | R mm | Z No | Insert | Vite Screw | Rondella Lock Washer | Vite Fissaggio Securing Screw | Torx Key |
|-------------|------|------|-------|------|------|------|----------|------------|----------------------|-------------------------------|----------|
| TRD16321602 | 32 | 43 | 16 | 17 | 8 | 2 | RD..1604 | A45M | R01 | A45 | T20 |

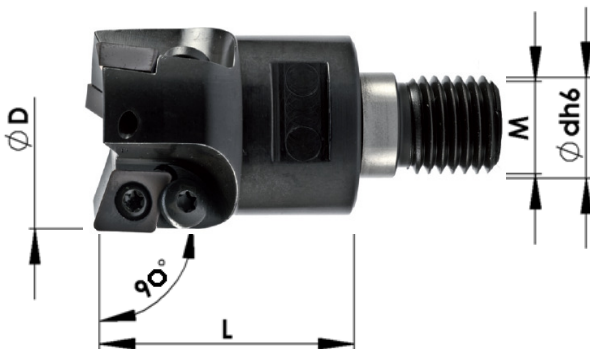

CON REFRIGERAZIONE INTERNA - WITH INTERNAL COOLANT

| CODE | D mm | L mm | M ISO | d mm | Z No | Insert | Vite Screw | Vite Fissaggio Securing Screw | Torx Key |
|-------------|------|------|-------|------|------|----------|------------|-------------------------------|----------|
| TXD90100602 | 10 | 18 | 6 | 6.5 | 2 | XD..0402 | A18M | - | T06 |
| TXD90120602 | 12 | 18 | 6 | 6.5 | 2 | | | - | |
| TXD90160802 | 16 | 23 | 8 | 8.5 | 2 | XD..0602 | A25M | - | T07 |
| TXD90201003 | 20 | 30 | 10 | 10.5 | 3 | | | - | |
| TXD90251203 | 25 | 35 | 12 | 12.5 | 3 | | | - | |
| TXD90251204 | 25 | 35 | 12 | 12.5 | 4 | XD..1003 | A38M | - | T15 |
| TXD90351603 | 35 | 43 | 16 | 17.0 | 3 | | | B35 | |
| TXD90421604 | 42 | 43 | 16 | 17.0 | 4 | | | B35 | |

TESTINA PER FRESARE

Threaded Milling Cutters

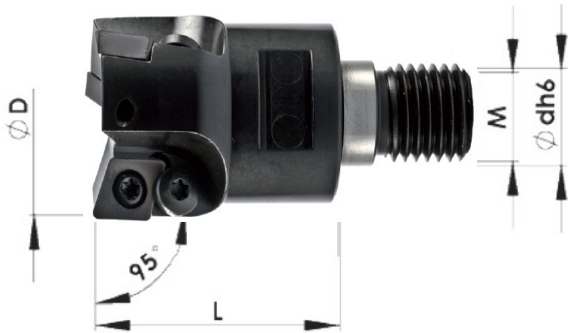

CON REFRIGERAZIONE INTERNA - WITH INTERNAL COOLANT

| CODE | D mm | L mm | M ISO | d mm | Z No | Insert | Vite Screw | Vite Fissaggio Securing Screw | Torx Key |
|-------------|------|------|-------|------|------|----------|------------|-------------------------------|----------|
| TXD95100602 | 10 | 18 | 6 | 6.5 | 2 | XD..0402 | A18M | - | T06 |
| TXD95120602 | 12 | 18 | 6 | 6.5 | 2 | | | - | |
| TXD95150603 | 15 | 18 | 6 | 6.5 | 3 | | | - | |
| TXD95160802 | 16 | 23 | 8 | 8.5 | 2 | XD..0602 | A25M | - | T07 |
| TXD95201003 | 20 | 30 | 10 | 10.5 | 3 | | | - | |
| TXD95251203 | 25 | 35 | 12 | 12.5 | 3 | | | - | |
| TXD95251204 | 25 | 35 | 12 | 12.5 | 4 | | | - | |
| TXD95351605 | 35 | 43 | 16 | 17 | 5 | | | - | |
| TXD95421606 | 42 | 43 | 16 | 17 | 6 | | | - | |
| TXD95351603 | 35 | 43 | 16 | 17 | 3 | XD..1003 | A38M | B35 | T15 |
| TXD95401604 | 40 | 43 | 16 | 17 | 4 | | | | |
| TXD95421604 | 42 | 43 | 16 | 17 | 4 | | | | |

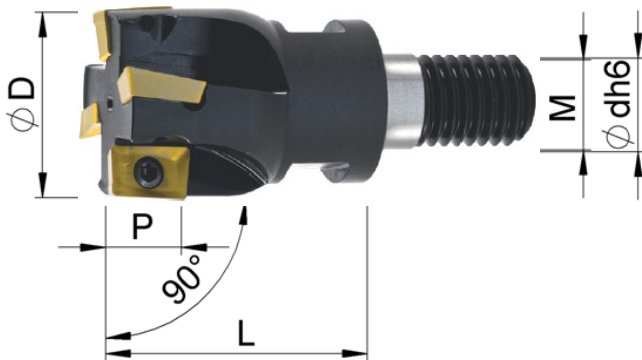

CON REFRIGERAZIONE INTERNA - WITH INTERNAL COOLANT

| CODE | D mm | L mm | P mm | M ISO | d mm | Z No | Insert | Vite Screw | Torx Key |
|---------------|------|------|------|-------|------|------|----------|------------|----------|
| TAP1016080210 | 16 | 25 | 10 | 8 | 8.5 | 2 | AP..1003 | A26M | T08 |
| TAP1020100310 | 20 | 30 | 10 | 10 | 10.5 | 3 | | | |
| TAP1025120410 | 25 | 35 | 10 | 12 | 12.5 | 4 | | | |
| TAP1032160510 | 32 | 43 | 10 | 16 | 17 | 5 | AP..1604 | A48M | T15 |
| TAP1025120216 | 25 | 35 | 16 | 12 | 12.5 | 2 | | A49M | |
| TAP1032160316 | 32 | 43 | 16 | 16 | 17 | 3 | | | |

TESTINA PER FRESARE
Threaded Milling Cutters

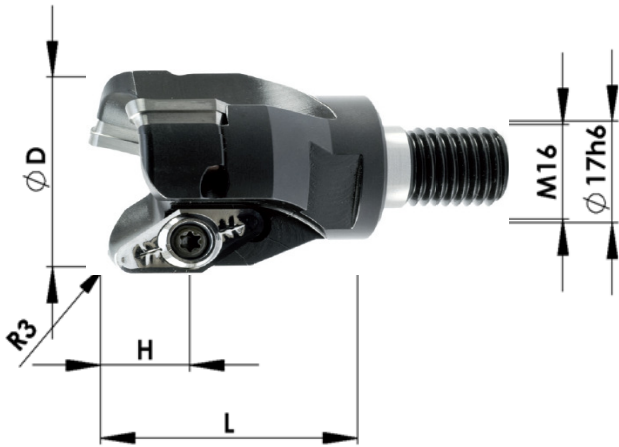

CON REFRIGERAZIONE INTERNA - WITH INTERNAL COOLANT

| CODE | D mm | L mm | H mm | R mm | Z No | Insert | Vite Screw | Torx Key |
|-------------|------|------|------|------|------|------------|------------|----------|
| TVC2232R302 | 32 | 48 | 15 | 3 | 2 | VC..220530 | A45M | T20 |
| TVC2242R303 | 42 | 48 | 15 | 3 | 3 | | | |

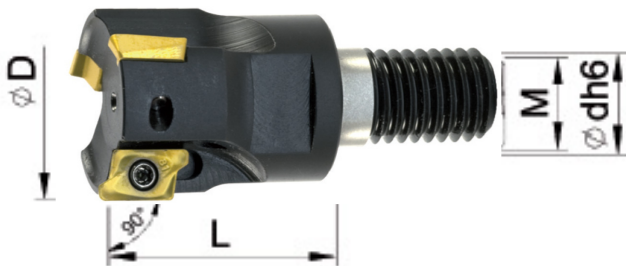

CON REFRIGERAZIONE INTERNA - WITH INTERNAL COOLANT

| CODE | D mm | L mm | M ISO | d mm | Z No | Insert | Vite Screw | Torx Key |
|-------------|------|------|-------|------|------|-------------|------------|----------|
| TRT10160802 | 16 | 25 | 8 | 8.5 | 2 | **RT1003/T3 | A27M | T08IP |
| TRT10201003 | 20 | 30 | 10 | 10.5 | 3 | | | |
| TRT10251203 | 25 | 35 | 12 | 12.5 | 3 | | | |
| TRT10251204 | 25 | 35 | 12 | 12.5 | 4 | | | |
| TRT10321605 | 32 | 43 | 16 | 17 | 5 | | | |

CON REFRIGERAZIONE INTERNA - WITH INTERNAL COOLANT

| CODE | D mm | L mm | M ISO | d mm | Z No | Insert | Vite Screw | Torx Key |
|-------------|------|------|-------|------|------|------------|------------|----------|
| TRT13201002 | 20 | 25 | 10 | 10.5 | 2 | **RT1304.. | A30M | T09IP |
| TRT13251203 | 25 | 30 | 12 | 12.5 | 3 | | | |
| TRT13321604 | 32 | 40 | 16 | 17 | 4 | | | |
| TRT13351605 | 35 | 40 | 16 | 17 | 5 | | | |

****FORNIBILI SOLO A RICHIESTA**
AVAILABLE ON DEMAND

TESTINA PER COPIATURA
Threaded Milling for Copy

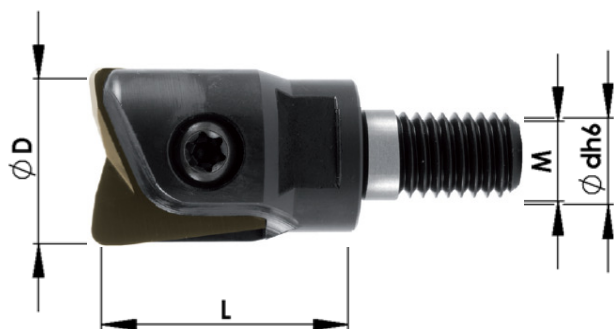

| CODE | D mm | L mm | M ISO | d mm | Insert | Vite Screw | Torx Key |
|-----------|------|------|-------|------|--------------|------------|----------|
| TWPV12060 | 12 | 20 | 6 | 6.5 | WPV..WPB12.. | A09M | T15 |
| TWPV16080 | 16 | 25 | 8 | 8.5 | WPV..WPB16.. | A10M | T20 |
| TWPV20100 | 20 | 30 | 10 | 10.5 | WPV..WPB20.. | A11M | |
| TWPV25120 | 25 | 35 | 12 | 12.5 | WPV..WPB25.. | A12M | T25 |
| TWPV32160 | 32 | 45 | 16 | 17 | WPV..WPB32.. | A13M | T30 |



| CODE | D mm | L mm | R mm | M ISO | d mm | Insert | Vite Screw | Torx Key |
|-----------|------|------|------|-------|------|---------|------------|----------|
| TWPR12060 | 12 | 20 | 6 | 6 | 6.5 | WPR12.. | A09M | T15 |
| TWPR16080 | 16 | 25 | 8 | 8 | 8.5 | WPR16.. | A10M | T20 |
| TWPR20100 | 20 | 30 | 10 | 10 | 10.5 | WPR20.. | A11M | |
| TWPR25125 | 25 | 35 | 12.5 | 12 | 12.5 | WPR25.. | A12M | T25 |
| TWPR32160 | 32 | 45 | 16 | 16 | 17 | WPR32.. | A13M | T30 |

TESTINA PER COPIATURA

Threaded Milling for Copy

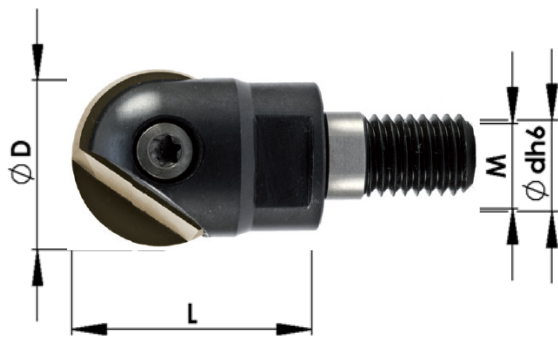

| CODE | D mm | L mm | R mm | M ISO | d mm | Insert | Vite Screw | Torx Key |
|--------------|------|------|------|-------|------|---------|------------|----------|
| TAWR1206R060 | 12 | 20 | 6 | 6 | 6.5 | AWR12.. | C09 | T10 |
| TAWR1608R080 | 16 | 25 | 8 | 8 | 8.5 | AWR16.. | C10 | T15 |
| TAWR2010R100 | 20 | 30 | 10 | 10 | 10.5 | AWR20.. | C11 | T20 |
| TAWR2512R125 | 25 | 35 | 12.5 | 12 | 12.5 | AWR25.. | C12 | T25 |
| TAWR3216R160 | 32 | 45 | 16 | 16 | 17 | AWR32.. | C13 | T30 |

TESTINA PER ELEVATI AVANZAMENTI

Milling for High Feed

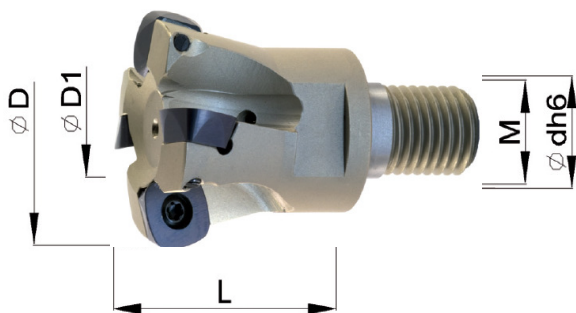

| CODE | D mm | D1 mm | L mm | M ISO | d mm | Z No | Insert | Vite Screw | Torx Key |
|-------------|------|-------|------|-------|------|------|-------------------|------------|----------|
| TSD12351603 | 35 | 17 | 40 | 16 | 17 | 3 | SD..1205 ZDTN-R15 | A49M | T15 |
| TSD12421604 | 42 | 24 | 40 | 16 | 17 | 4 | | A50M | |

PROLUNGHE PER ATTACCHI FILETTATI

Extensions for Milling Cutters Modular Type

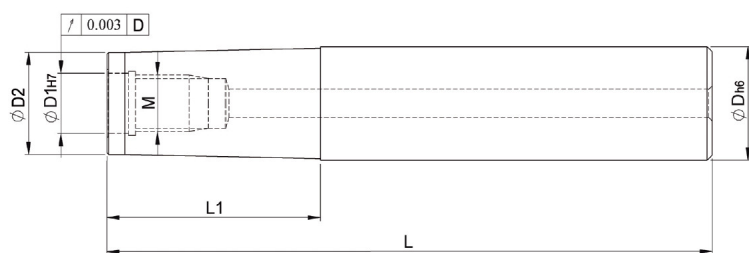

Acciaio - Steel

| CODE | D mm | M ISO | L mm | L1 mm | D1 mm | D2 mm |
|------------|------|-------|------|-------|-------|-------|
| PRG1206160 | 12 | 6 | 160 | 40 | 6.5 | 9.8 |
| PRG1608160 | 16 | 8 | 160 | 45 | 8.5 | 12.8 |
| PRG1608200 | 16 | 8 | 200 | 10 | 8.5 | 14 |
| PRG2010160 | 20 | 10 | 160 | 50 | 10.5 | 17.8 |
| PRG2010250 | 20 | 10 | 250 | 12 | 10.5 | 18 |
| PRG2512160 | 25 | 12 | 160 | 55 | 12.5 | 20.8 |
| PRG2512250 | 25 | 12 | 250 | 15 | 12.5 | 23 |
| PRG3216160 | 32 | 16 | 160 | 60 | 17 | 28.8 |
| PRG3216300 | 32 | 16 | 300 | 18 | 17 | 29 |

Metallo Duro – Solid Carbide

| CODE | D mm | M ISO | L mm | D1 mm |
|-------------|------|-------|------|-------|
| PRGM1106100 | 11 | 6 | 100 | 6.5 |
| PRGM1106150 | 11 | 6 | 150 | 6.5 |
| PRGM1206100 | 12 | 6 | 100 | 6.5 |
| PRGM1206150 | 12 | 6 | 150 | 6.5 |
| PRGM1508100 | 15 | 8 | 100 | 8.5 |
| PRGM1508150 | 15 | 8 | 150 | 8.5 |
| PRGM1508200 | 15 | 8 | 200 | 8.5 |
| PRGM1608100 | 16 | 8 | 100 | 8.5 |
| PRGM1608150 | 16 | 8 | 150 | 8.5 |
| PRGM1608200 | 16 | 8 | 200 | 8.5 |
| PRGM1910100 | 19 | 10 | 100 | 10.5 |
| PRGM1910150 | 19 | 10 | 150 | 10.5 |
| PRGM1910200 | 19 | 10 | 200 | 10.5 |
| PRGM2010100 | 20 | 10 | 100 | 10.5 |
| PRGM2010150 | 20 | 10 | 150 | 10.5 |
| PRGM2010200 | 20 | 10 | 200 | 10.5 |
| PRGM2412150 | 24 | 12 | 150 | 12.5 |
| PRGM2412200 | 24 | 12 | 200 | 12.5 |
| PRGM2412250 | 24 | 12 | 250 | 12.5 |
| PRGM2512150 | 25 | 12 | 150 | 12.5 |
| PRGM2512200 | 25 | 12 | 200 | 12.5 |
| PRGM2512250 | 25 | 12 | 250 | 12.5 |
| PRGM3216250 | 32 | 16 | 250 | 17 |
| PRGM3216300 | 32 | 16 | 300 | 17 |
| PRGM3216400 | 32 | 16 | 400 | 17 |

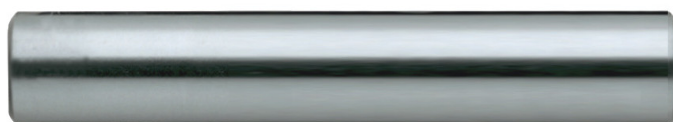
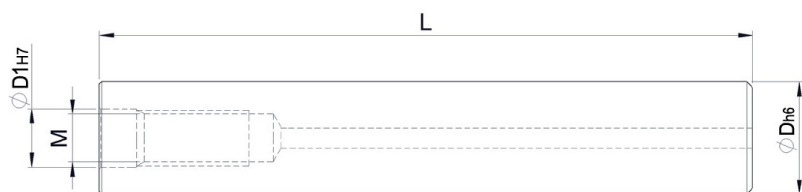

FRESE PER COPIATURA

Threaded Milling for Cop

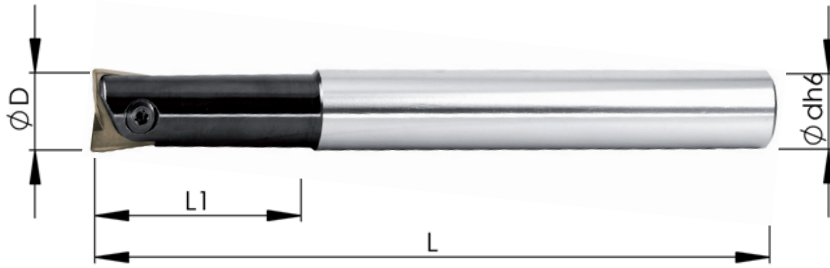

CORPO IN ACCIAIO – STEEL SHANK

| CODE | D mm | L1 mm | L mm | d mm | Insert | Vite Screw | Torx Key |
|---------------------|------|-------|------|------|-------------|------------|----------|
| FWPVL0810120 | 8 | 40 | 120 | 8 | WPV-WPB08.. | A07M | T08 |
| FWPVL0830120 | 8 | 30 | 120 | 10 | | | |
| FWPVL1040120 | 10 | 40 | 120 | 10 | WPV-WPB10.. | A08M | T15 |
| FWPVL1035150 | 10 | 35 | 150 | 12 | | | |
| FWPVL1250160 | 12 | 50 | 160 | 12 | WPV-WPB12.. | A09M | T20 |
| FWPVL1653175 | 16 | 53 | 175 | 16 | WPV-WPB16.. | A10M | |
| FWPVL2061190 | 20 | 61 | 190 | 20 | WPV-WPB20.. | A11M | |
| FWPVL2570190 | 25 | 70 | 190 | 25 | WPV-WPB25.. | A12M | T30 |
| FWPVL3280210 | 32 | 80 | 210 | 32 | WPV-WPB32.. | A13M | |

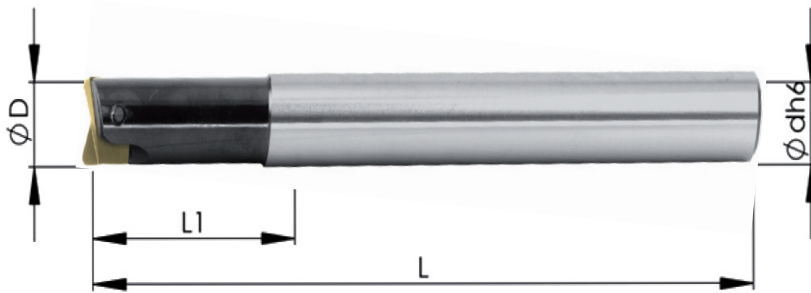

CORPO IN ACCIAIO – STEEL SHANK

| CODE | D mm | L1 mm | L mm | d mm | Insert | Vite Screw | Torx Key |
|----------------------|------|-------|------|------|----------|------------|----------|
| FPPHTL1235140 | 12 | 35 | 140 | 12 | PPHT12.. | C09 | T10 |
| FPPHTL1645170 | 16 | 45 | 170 | 16 | PPHT16.. | C10 | T15 |
| FPPHTL2055180 | 20 | 55 | 180 | 20 | PPHT20.. | C11 | T20 |
| FPPHTL2560200 | 25 | 60 | 200 | 25 | PPHT25.. | C12 | T25 |

FRESE PER COPIATURA
Threaded Milling for Cop

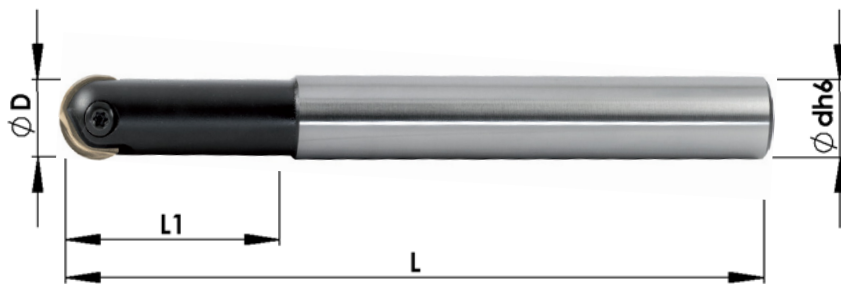

CORPO IN ACCIAIO – STEEL SHANK

| CODE | D mm | L1 mm | L mm | d mm | R mm | Insert | Vite Screw | Torx Key |
|--------------|------|-------|------|------|------|---------|------------|----------|
| FWPRL0625090 | 6 | 25 | 90 | 10 | 3 | WPR06.. | A00M | T06 |
| FWPRL0810120 | 8 | 40 | 120 | 8 | 4 | WPR08.. | A07M | T08 |
| FWPRL0830120 | 8 | 30 | 120 | 10 | 4 | | | |
| FWPRL1040120 | 10 | 40 | 150 | 10 | 5 | WPR10.. | A08M | T15 |
| FWPRL1035150 | 10 | 35 | 150 | 12 | 5 | | | |
| FWPRL1250160 | 12 | 50 | 160 | 12 | 6 | WPR12.. | A09M | T20 |
| FWPRL1653175 | 16 | 53 | 175 | 16 | 8 | WPR16.. | A10M | |
| FWPRL2061190 | 20 | 61 | 190 | 20 | 10 | WPR20.. | A11M | T30 |
| FWPRL2570190 | 25 | 70 | 190 | 25 | 12.5 | WPR25.. | A12M | |
| FWPRL3280210 | 32 | 80 | 210 | 32 | 16 | WPR32.. | A13M | |

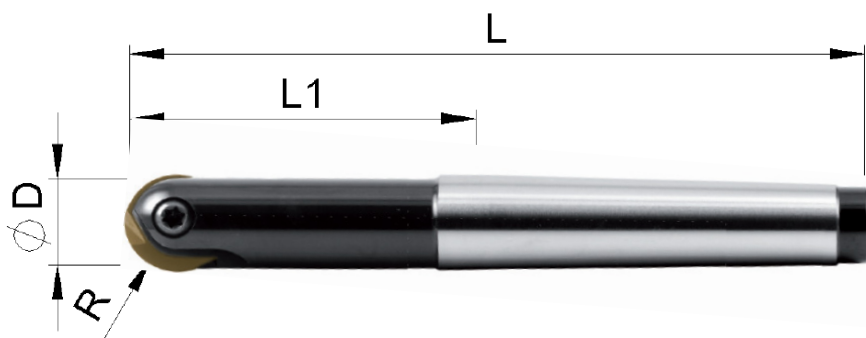

CORPO IN ACCIAIO – STEEL SHANK

| CODE | D mm | L1 mm | L mm | R mm | CM | Insert | Vite Screw | Torx Key |
|--------------|------|-------|------|------|----|---------|------------|----------|
| FWPRC1655125 | 16 | 55 | 125 | 8 | 2 | WPR16.. | A11M | T20 |
| FWPRC2070140 | 20 | 70 | 140 | 10 | 2 | WPR20.. | | |
| FWPRC2570170 | 25 | 70 | 170 | 12.5 | 3 | WPR25.. | A12M | T25 |
| FWPRC3280190 | 32 | 80 | 190 | 16 | 4 | WPR32.. | A13M | T30 |
| FWPRC3295205 | 32 | 95 | 205 | 16 | 4 | | | |

FRESE FORANTI

Drilling End Mills

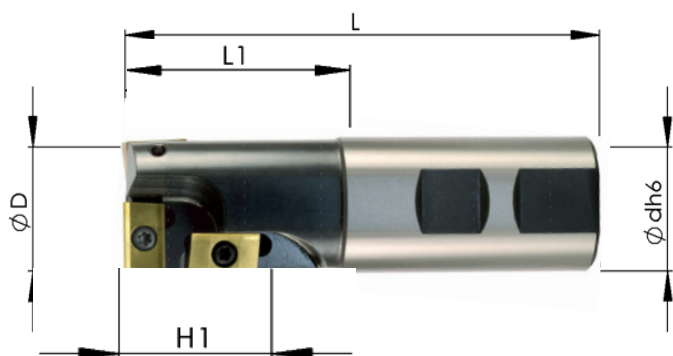

CON REFRIGERAZIONE INTERNA - WITH INTERNAL COOLANT

| CODE | D mm | H1 mm | L1 mm | L mm | d mm | Inserts No | Z No | Insert | Vite Screw | Torx Key |
|--------------|---------|----------|----------|---------|---------|---------------|---------|----------|---------------|-------------|
| FAP102017090 | 20 | 17 | 35 | 90 | 20 | 3 | 2 | AP..1003 | A26M | T08 |
| FAP103230130 | 32 | 30 | 50 | 130 | 32 | 3 | 2 | AP..1604 | A49M | T15 |

FRESE PER SPALLAMENTI

Shoulder Milling Cutters



CON REFRIGERAZIONE INTERNA - WITH INTERNAL COOLANT

| CODE | D mm | L1 mm | L mm | d mm | Z No | Insert | Vite Screw | Torx Key |
|--------------|---------|----------|---------|---------|---------|----------|---------------|-------------|
| FAPS10248001 | 10 | 24 | 80 | 16 | 1 | AP..1003 | A26M | T08 |
| FAPS12248001 | 12 | 24 | 80 | 16 | 1 | | | |
| FAPS14248001 | 14 | 24 | 80 | 16 | 1 | | | |
| FAPS16258502 | 16 | 25 | 85 | 16 | 2 | | | |
| FAPS17258502 | 17 | 25 | 85 | 16 | 2 | | | |
| FAPS18258502 | 18 | 25 | 85 | 20 | 2 | | | |
| FAPS20259003 | 20 | 25 | 90 | 20 | 3 | | | |
| FAPS22259003 | 22 | 25 | 90 | 20 | 3 | | | |
| FAPS24259503 | 24 | 25 | 95 | 25 | 3 | | | |
| FAPS25259503 | 25 | 25 | 95 | 25 | 3 | | | |
| FAPS25259504 | 25 | 25 | 95 | 25 | 4 | | | |
| FAPS32269505 | 32 | 26 | 95 | 25 | 5 | | | |

FRESE PER SPALLAMENTI
Shoulder Milling Cutters



CON REFRIGERAZIONE INTERNA - WITH INTERNAL COOLANT

| CODE | D mm | L 1 mm | L mm | d mm | Z No | Insert | Vite Screw | Torx Key |
|---------------|------|--------|------|------|------|----------|------------|----------|
| FAPSL10241501 | 10 | 24 | 150 | 16 | 1 | AP..1003 | A26M | T08 |
| FAPSL12241501 | 12 | 24 | 150 | 16 | 1 | | | |
| FAPSL16241502 | 16 | 24 | 150 | 16 | 2 | | | |
| FAPSL20251503 | 20 | 25 | 150 | 20 | 3 | | | |
| FAPSL25251504 | 25 | 25 | 150 | 20 | 4 | | | |
| FAPSL32261505 | 32 | 26 | 150 | 25 | 5 | | | |

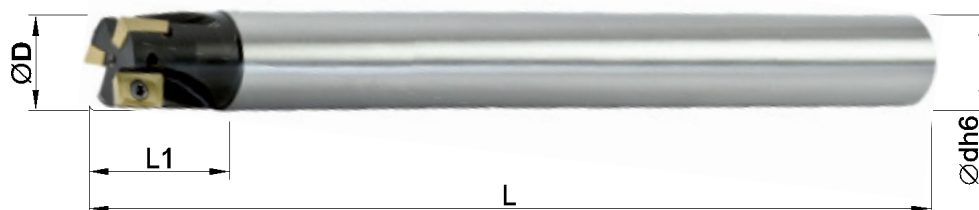

CON REFRIGERAZIONE INTERNA - WITH INTERNAL COOLANT

| CODE | D mm | L 1 mm | L mm | d mm | Z No | Insert | Vite Screw | Torx Key |
|--------------|------|--------|------|------|------|----------|------------|----------|
| FAPXL1615200 | 16 | 24 | 200 | 15 | 2 | AP..1003 | A26M | T08 |
| FAPXL1616200 | 16 | 24 | 200 | 16 | 2 | | | |
| FAPXL2019200 | 20 | 25 | 200 | 19 | 3 | | | |
| FAPXL2020200 | 20 | 25 | 200 | 20 | 3 | | | |
| FAPXL2524200 | 25 | 25 | 200 | 24 | 3 | | | |
| FAPXL2525200 | 25 | 25 | 200 | 25 | 3 | | | |
| FAPXL2524201 | 25 | 25 | 200 | 24 | 4 | | | |
| FAPXL2525201 | 25 | 25 | 200 | 25 | 4 | | | |

FRESE PER SPALLAMENTI
Shoulder Milling Cutters

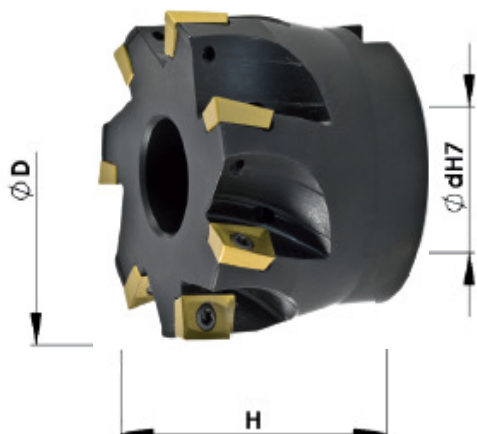

CON REFRIGERAZIONE INTERNA - WITH INTERNAL COOLANT

| CODE | D mm | H mm | d mm | Z No | Insert | Vite Screw | Torx Key |
|--------------|------|------|------|------|----------|------------|----------|
| SPAP10401606 | 40 | 40 | 16 | 6 | AP..1003 | A26M | T08 |
| SPAP10402206 | 40 | 40 | 22 | 6 | | | |
| SPAP10502205 | 50 | 40 | 22 | 5 | | | |
| SPAP10502207 | 50 | 40 | 22 | 7 | | | |
| SPAP10632206 | 63 | 40 | 22 | 6 | | | |
| SPAP10632208 | 63 | 40 | 22 | 8 | | | |
| SPAP10802711 | 80 | 50 | 27 | 11 | | | |

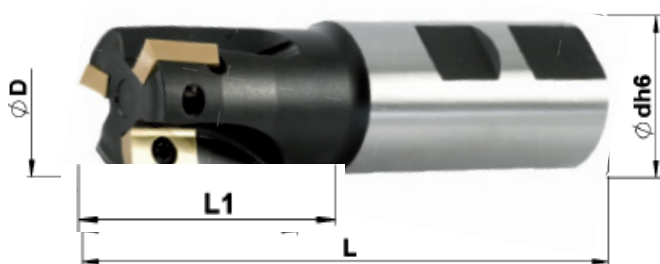

CON REFRIGERAZIONE INTERNA - WITH INTERNAL COOLANT

| CODE | D mm | L1 mm | L mm | d mm | Z No | Insert | Vite Screw | Torx Key |
|--------------|------|-------|------|------|------|----------|------------|----------|
| FAP162544100 | 25 | 44 | 100 | 25 | 2 | AP..1604 | A48M | T15 |
| FAP162844100 | 28 | 44 | 100 | 25 | 3 | | A49M | |
| FAP163250110 | 32 | 50 | 110 | 32 | 3 | | | |
| FAP162540115 | 40 | 45 | 115 | 32 | 4 | | | |

FRESE PER SPALLAMENTI

Shoulder Milling Cutters

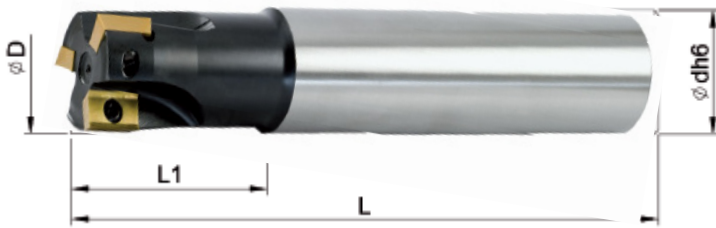

CON REFRIGERAZIONE INTERNA - WITH INTERNAL COOLANT

| CODE | D mm | L1 mm | L mm | d mm | Z No | Insert | Vite Screw | Torx Key |
|-----------------|------|-------|------|------|------|----------|------------|----------|
| FAP16L2560180 | 25 | 60 | 180 | 20 | 2 | AP..1604 | A48M | T15 |
| FAP16L3260180 | 32 | 60 | 180 | 25 | 3 | | A49M | |
| FAP16L3260180.1 | 32 | 60 | 180 | 32 | 3 | | | |

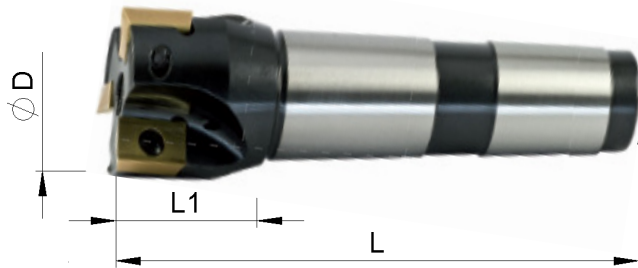

CON REFRIGERAZIONE INTERNA - WITH INTERNAL COOLANT

| CODE | D mm | L1 mm | L mm | CM | Z No | Insert | Vite Screw | Torx Key |
|---------------|------|-------|------|----|------|----------|------------|----------|
| FAP16C3240125 | 32 | 40 | 125 | 3 | 3 | AP..1604 | A49M | T15 |
| FAP16C4048157 | 40 | 48 | 157 | 4 | 4 | | | |

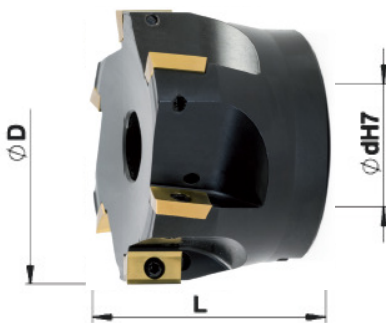

CON REFRIGERAZIONE INTERNA - WITH INTERNAL COOLANT

| CODE | D mm | L mm | d mm | Z No | Insert | Vite Screw | Torx Key |
|---------------|------|------|------|------|----------|------------|----------|
| SPAP160401604 | 40 | 40 | 16 | 4 | AP..1604 | A49M | T15 |
| SPAP160502205 | 50 | 40 | 22 | 5 | | | |
| SPAP160632205 | 63 | 40 | 22 | 5 | | | |
| SPAP160632206 | 63 | 40 | 22 | 6 | | | |
| SPAP160802706 | 80 | 50 | 27 | 6 | | | |
| SPAP161003207 | 100 | 50 | 32 | 7 | | | |
| SPAP161254008 | 125 | 63 | 40 | 8 | | | |
| SPAP161604010 | 160 | 63 | 40 | 10 | | | |

FRESE PER SPALLAMENTI
Shoulder Milling Cutters



CON REFRIGERAZIONE INTERNA - WITH INTERNAL COOLANT

| CODE | D mm | L1 mm | L mm | d mm | Z No | Insert | Vite Screw | Torx Key |
|--------------|------|-------|------|------|------|----------|------------|----------|
| FAD152544100 | 25 | 44 | 100 | 25 | 2 | ADKT1505 | A49M | T15 |
| FAD153250110 | 32 | 50 | 110 | 32 | 3 | | | |
| FAD154045115 | 40 | 45 | 115 | 32 | 4 | | | |

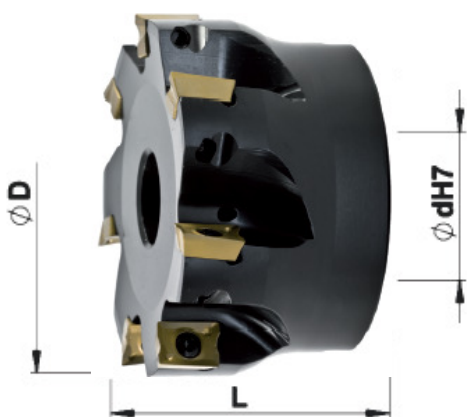

CON REFRIGERAZIONE INTERNA - WITH INTERNAL COOLANT

| CODE | D mm | L mm | d mm | Z No | Insert | Vite Screw | Torx Key |
|---------------|------|------|------|------|----------|------------|----------|
| SPAD150401604 | 40 | 45 | 16 | 4 | ADKT1505 | A49M | T15 |
| SPAD150502205 | 50 | 40 | 22 | 5 | | | |
| SPAD150632206 | 63 | 40 | 22 | 6 | | | |
| SPAD150802707 | 80 | 50 | 27 | 7 | | | |
| SPAD151003208 | 100 | 50 | 32 | 8 | | | |
| SPAD151254009 | 125 | 63 | 40 | 9 | | | |

FRESE PER FORTI AVANZAMENTI

High Feed end Mills

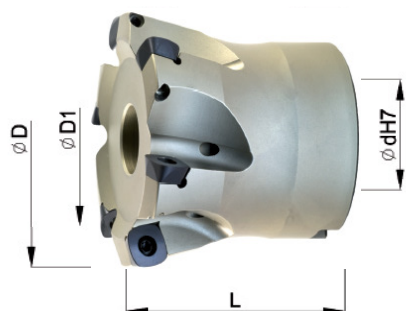

CON REFRIGERAZIONE INTERNA - WITH INTERNAL COOLANT

| CODE | D mm | D1 mm | L mm | d mm | Z No | Insert | Vite Screw | Torxl Key |
|----------------|------|-------|------|------|------|----------------------|------------|-----------|
| SPSD12F0421604 | 42 | 24 | 45 | 16 | 4 | SD..1205 ZDTN-R15 | A50M | T15 |
| SPSD12F0522205 | 52 | 34 | 50 | 22 | 5 | | | |
| SPSD12F0662705 | 66 | 48 | 50 | 27 | 5 | | | |
| SPSD12F0802706 | 80 | 62 | 70 | 27 | 6 | | | |
| SPSD12F1003208 | 100 | 82 | 70 | 32 | 8 | | | |

FRESE PER SPALLAMENTI

Shoulder Milling Cutters

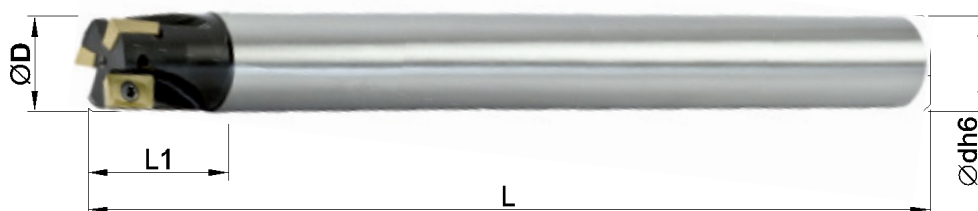

CON REFRIGERAZIONE INTERNA - WITH INTERNAL COOLANT

| CODE | D mm | L1 mm | L mm | d mm | Z No | Insert | Vite Screw | Torx Key |
|--------------|------|-------|------|------|------|-------------|------------|----------|
| FRT101630160 | 16 | 30 | 160 | 16 | 2 | **RT1003/T3 | A27M | T08IP |
| FRT101625160 | 16 | 25 | 160 | 15 | 2 | | | |
| FRT102030200 | 20 | 30 | 200 | 20 | 3 | | | |
| FRT102025200 | 20 | 25 | 200 | 19 | 3 | | | |
| FRT102530200 | 25 | 30 | 200 | 25 | 3 | | | |
| FRT102525200 | 25 | 25 | 200 | 24 | 3 | | | |

CON REFRIGERAZIONE INTERNA - WITH INTERNAL COOLANT

| CODE | D mm | L1 mm | L mm | d mm | Z No | Insert | Vite Screw | Torx Key |
|-----------------|------|-------|------|------|------|------------|------------|----------|
| FRT13L2030200 | 20 | 30 | 200 | 20 | 2 | **RT1304.. | A30M | T09IP |
| FRT13L2030200.1 | 20 | 30 | 200 | 19 | 2 | | | |
| FRT13L2535200 | 25 | 35 | 200 | 25 | 3 | | | |
| FRT13L2535200.1 | 25 | 35 | 200 | 24 | 3 | | | |
| FRT13L3240200 | 32 | 40 | 200 | 32 | 4 | | | |

****FORNIBILI SOLO A RICHIESTA
AVAILABLE ON DEMAND**

FRESE PER SPALLAMENTI
Shoulder Milling Cutters

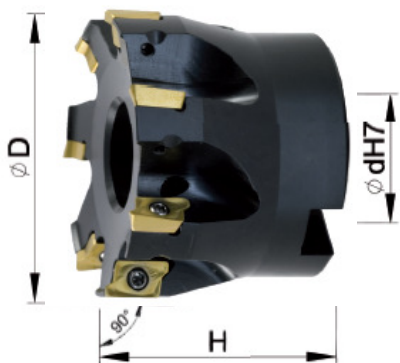

CON REFRIGERAZIONE INTERNA - WITH INTERNAL COOLANT

| CODE | D mm | H mm | d mm | Z No | Insert | Vite Screw | Torx Key |
|--------------|------|------|------|------|-------------|------------|----------|
| SPRT10401606 | 40 | 40 | 16 | 6 | **RT1003/T3 | A27M | T08IP |
| SPRT10502207 | 50 | 40 | 22 | 7 | | | |

CON REFRIGERAZIONE INTERNA - WITH INTERNAL COOLANT

| CODE | D mm | H mm | d mm | Z No | Insert | Vite Screw | Torx Key |
|--------------|------|------|------|------|------------|------------|----------|
| SPRT13401605 | 40 | 40 | 16 | 5 | **RT1304.. | A30M | T09IP |
| SPRT13502206 | 50 | 40 | 22 | 6 | | | |
| SPRT13632207 | 63 | 40 | 22 | 7 | | | |

****FORNIBILI SOLO A RICHIESTA
AVAILABLE ON DEMAND**

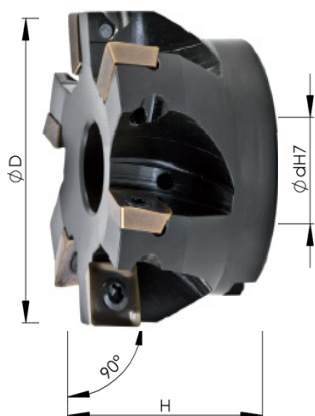

CON REFRIGERAZIONE INTERNA - WITH INTERNAL COOLANT

| CODE | D mm | H mm | d mm | Z No | Insert | Vite Screw | Torx Key |
|---------------|------|------|------|------|----------|------------|----------|
| SPSD120502205 | 50 | 40 | 22 | 5 | SDHT1204 | A49M | T15 |
| SPSD120632206 | 63 | 40 | 22 | 6 | | | |
| SPSD120802706 | 80 | 50 | 27 | 6 | | | |
| SPSD121003208 | 100 | 50 | 32 | 8 | | | |
| SPSD121254009 | 125 | 63 | 40 | 9 | | | |

FRESE PER SPALLAMENTI

Shoulder Milling Cutters

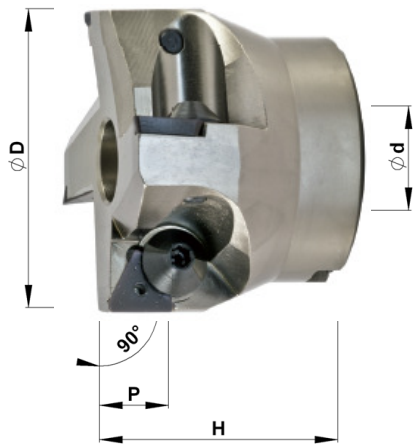

CON REFRIGERAZIONE INTERNA - WITH INTERNAL COOLANT

| CODE | D mm | H mm | d mm | Z No | Insert | Vite Screw | Exagonal Key |
|----------------|------|------|------|------|-----------|------------|--------------|
| SPTPK160502203 | 50 | 50 | 22 | 3 | TPK..1603 | D01 | 4mm |
| SPTPK160632204 | 63 | 50 | 22 | 4 | | | |
| SPTPK160802705 | 80 | 50 | 27 | 5 | | | |
| SPTPK161003206 | 100 | 50 | 32 | 6 | | | |
| SPTPK161254006 | 125 | 63 | 40 | 6 | | | |

| CODE | D mm | H mm | d mm | Z No | Insert | Vite Screw | Exagonal Key |
|----------------|------|------|------|------|-----------|------------|--------------|
| SPTPK220632203 | 63 | 50 | 22 | 3 | TPK..2204 | D02 | 5mm |
| SPTPK220802704 | 80 | 50 | 27 | 4 | | | |
| SPTPK221003205 | 100 | 50 | 32 | 5 | | | |
| SPTPK221254006 | 125 | 63 | 40 | 6 | | | |
| SPTPK221604007 | 160 | 63 | 40 | 7 | | | |



CON REFRIGERAZIONE INTERNA - WITH INTERNAL COOLANT

| CODE | D mm | L mm | d mm | H mm | Z No | Insert | Vite Screw | Torx Key |
|---------------|------|------|------|------|------|------------|------------|----------|
| SPVC220421603 | 42 | 57 | 18 | 15 | 3 | VC..220530 | A45M | T20 |
| SPVC220522203 | 52 | 57 | 22 | 15 | 3 | | | |
| SPVC220662704 | 66 | 57 | 27 | 15 | 4 | | | |
| SPVC220802704 | 80 | 57 | 27 | 15 | 4 | | | |
| SPVC221003205 | 100 | 55 | 32 | 15 | 5 | | | |
| SPVC221254006 | 125 | 55 | 40 | 15 | 6 | | | |

FRESE PER SPALLAMENTI

Shoulder Milling Cutters

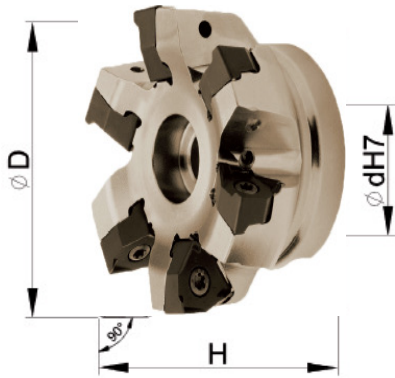

CON REFRIGERAZIONE INTERNA - WITH INTERNAL COOLANT

| CODE | D mm | H mm | d mm | Z No | Insert | Vite Screw | Torx Key |
|--------------|---------|---------|---------|---------|-------------|---------------|-------------|
| SPXN08502204 | 50 | 40 | 22 | 4 | XNEX 080608 | A50M | T15 |
| SPXN08502205 | 50 | 40 | 22 | 5 | | | |
| SPXN08632205 | 63 | 40 | 22 | 5 | | | |
| SPXN08632206 | 63 | 40 | 22 | 6 | | | |
| SPXN08802706 | 80 | 50 | 27 | 6 | | | |
| SPXN08802707 | 80 | 50 | 27 | 7 | | | |

FRESE PER SPIANATURE

Shoulder Milling Cutters

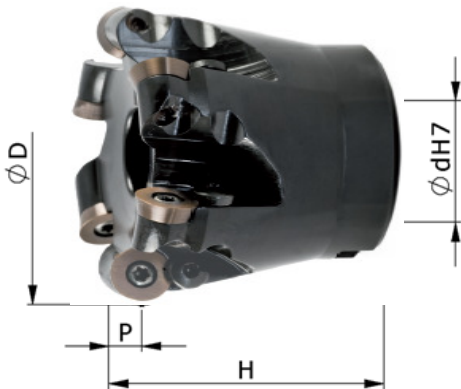

CON REFRIGERAZIONE INTERNA - WITH INTERNAL COOLANT

| CODE | D mm | H mm | d mm | P mm | Z No | Insert | Vite Screw | Securing Screw | Torx Key |
|----------------|---------|---------|---------|---------|---------|----------|---------------|-------------------|-------------|
| SPRD12T0401604 | 40 | 40 | 16 | 6 | 4 | RD..12T3 | A38M | B35 | T15 |
| SPRD12T0502205 | 50 | 50 | 22 | 6 | 5 | | | | |
| SPRD12T0522204 | 52 | 50 | 22 | 6 | 4 | | | | |
| SPRD12T0522205 | 52 | 50 | 22 | 6 | 5 | | | | |
| SPRD12T0632206 | 63 | 50 | 22 | 6 | 6 | | | | |
| SPRD12T0662706 | 66 | 50 | 27 | 6 | 6 | | | | |
| SPRD12T0802706 | 80 | 50 | 27 | 6 | 6 | | | | |
| SPRD12T0802707 | 80 | 50 | 27 | 6 | 7 | | | | |

FRESE PER SPIANATURE

Shoulder Milling Cutters

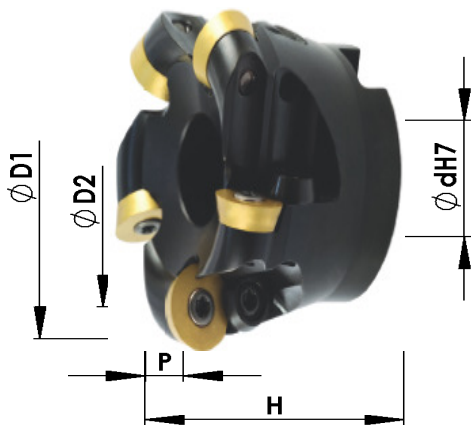

CON REFRIGERAZIONE INTERNA - WITH INTERNAL COOLANT

| CODE | D mm | H mm | d mm | P mm | Z No | Insert | Vite Screw | Torx Key |
|---------------|------|------|------|------|------|----------|------------|----------|
| SPRD120401604 | 40 | 40 | 16 | 6 | 4 | RD..1204 | A49M | T15 |
| SPRD120502204 | 50 | 50 | 22 | 6 | 4 | | | |
| SPRD120522205 | 52 | 50 | 22 | 6 | 5 | | | |
| SPRD120632705 | 63 | 50 | 27 | 6 | 5 | | | |
| SPRD120802706 | 80 | 50 | 27 | 6 | 6 | | | |
| SPRD121003207 | 100 | 55 | 32 | 6 | 7 | | | |

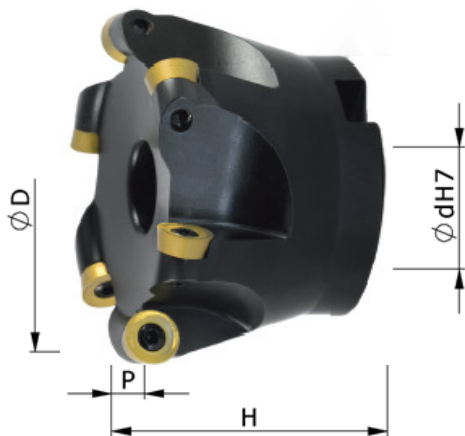

CON REFRIGERAZIONE INTERNA - WITH INTERNAL COOLANT

| CODE | D mm | H mm | d mm | P mm | Z No | Insert | Vite Screw | Lock Washer | Lock Washer Screw | Torx Key |
|---------------|------|------|------|------|------|----------|------------|-------------|-------------------|----------|
| SPRD160502204 | 50 | 50 | 22 | 8 | 4 | RD..1604 | A45M | R01 | A45M | T20 |
| SPRD160522204 | 52 | 50 | 22 | 8 | 4 | | | | | |
| SPRD160632705 | 63 | 50 | 27 | 8 | 5 | | | | | |
| SPRD160662705 | 66 | 50 | 27 | 8 | 5 | | | | | |
| SPRD160802706 | 80 | 50 | 27 | 8 | 6 | | | | | |
| SPRD161003207 | 100 | 55 | 32 | 8 | 7 | | | | | |
| SPRD161254008 | 125 | 63 | 40 | 8 | 8 | | | | | |
| SPRD161604009 | 160 | 55 | 40 | 8 | 9 | | | | | |

FRESE PER SPIANATURE

Shoulder Milling Cutters

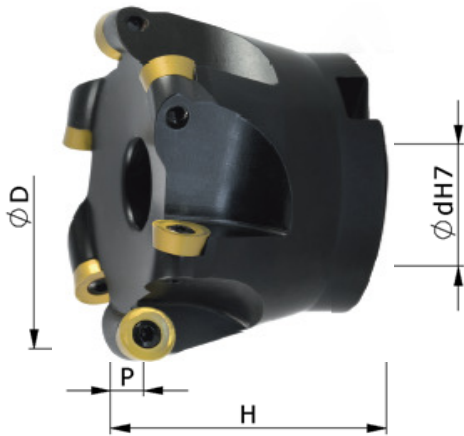

CON REFRIGERAZIONE INTERNA - WITH INTERNAL COOLANT

| CODE | D mm | H mm | d mm | P mm | Z No | Insert | Vite Screw | Torx Key |
|---------------|---------|---------|---------|---------|---------|----------|---------------|-------------|
| SPRP120401604 | 40 | 40 | 16 | 6 | 4 | RP..1204 | A49M | T15 |
| SPRP120502204 | 50 | 40 | 22 | 6 | 4 | | | |
| SPRP120522204 | 52 | 40 | 22 | 6 | 4 | | | |
| SPRP120632705 | 63 | 50 | 27 | 6 | 5 | | | |
| SPRP120662705 | 66 | 50 | 27 | 6 | 5 | | | |
| SPRP120802706 | 80 | 50 | 27 | 6 | 6 | | | |
| SPRP121003207 | 100 | 55 | 32 | 6 | 7 | | | |

FRESE PER SPIANATURE 43°

Shoulder Milling Cutters

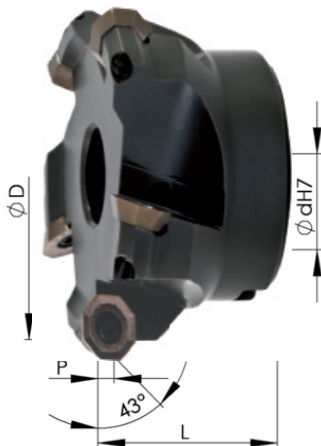

CON REFRIGERAZIONE INTERNA - WITH INTERNAL COOLANT

| CODE | D mm | L mm | d mm | P mm | Z No | Insert | Vite Screw | Torx Key |
|---------------|---------|---------|---------|---------|---------|----------|---------------|-------------|
| SPOF054303216 | 32 | 40 | 16 | 3.5 | 3 | OF..05T3 | A49M | T15 |
| SPOF054304016 | 40 | 40 | 16 | 3.5 | 3 | | | |
| SPOF054305022 | 50 | 40 | 22 | 3.5 | 4 | | | |
| SPOF054306322 | 63 | 40 | 22 | 3.5 | 5 | | | |
| SPOF054308027 | 80 | 50 | 27 | 3.5 | 6 | | | |
| SPOF054310032 | 100 | 50 | 32 | 3.5 | 7 | | | |
| SPOF054312540 | 125 | 63 | 40 | 3.5 | 8 | | | |

FRESE PER SPIANATURE 43°

Shoulder Milling Cutters

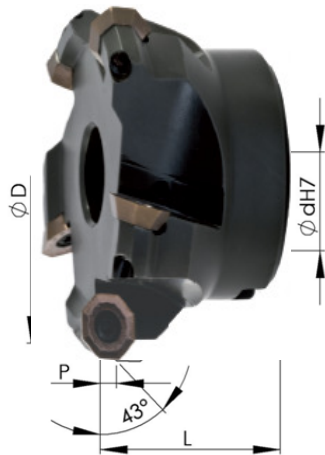

CON REFRIGERAZIONE INTERNA - WITH INTERNAL COOLANT

| CODE | D mm | L mm | d mm | P mm | Z No | Insert | Vite Screw | Torx Key |
|---------------|---------|---------|---------|---------|---------|----------|---------------|-------------|
| SPOD064305022 | 50 | 40 | 22 | 4.5 | 4 | OD..0605 | F03 | T20 |
| SPOD064306322 | 63 | 40 | 22 | 4.5 | 5 | | | |
| SPOD064308027 | 80 | 50 | 27 | 4.5 | 5 | | | |
| SPOD064310032 | 100 | 55 | 32 | 4.5 | 6 | | | |
| SPOD064312540 | 125 | 63 | 40 | 4.5 | 7 | | | |
| SPOD064316040 | 160 | 63 | 40 | 4.5 | 9 | | | |

FRESE PER SPIANATURE 45°

Shoulder Milling Cutters

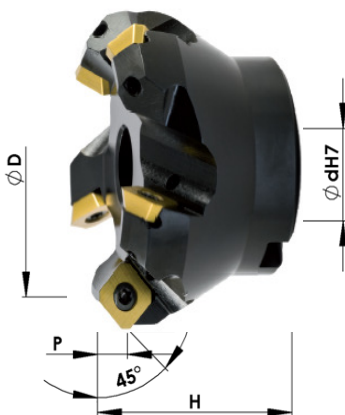

CON REFRIGERAZIONE INTERNA - WITH INTERNAL COOLANT

| CODE | D mm | H mm | d mm | P mm | Z No | Insert | Vite Screw | Torx Key |
|---------------|---------|---------|---------|---------|---------|----------|---------------|-------------|
| SPSD124505022 | 50 | 45 | 22 | 6 | 4 | SDKT1204 | E02 | T20 |
| SPSD124506322 | 63 | 45 | 22 | 6 | 5 | | | |
| SPSD124508027 | 80 | 50 | 27 | 6 | 6 | | | |
| SPSD124510032 | 100 | 55 | 32 | 6 | 7 | | | |
| SPSD124512540 | 125 | 63 | 40 | 6 | 8 | | | |

FRESE PER SPIANATURE 45°
Shoulder Milling cutters

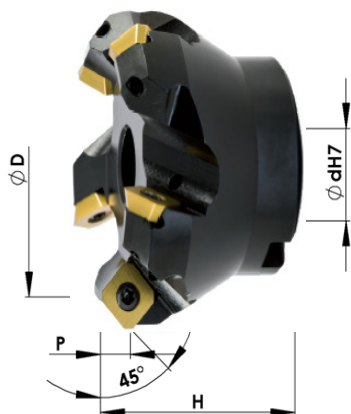

CON REFRIGERAZIONE INTERNA - WITH INTERNAL COOLANT

| CODE | D mm | H mm | d mm | P mm | Z No | Insert | Vite Screw | Torx Key |
|---------------|---------|---------|---------|---------|---------|----------|---------------|-------------|
| SPSE124504016 | 40 | 40 | 16 | 6 | 3 | SE..1204 | F01 | T20 |
| SPSE124505022 | 50 | 48 | 22 | 6 | 4 | | F02 | |
| SPSE124506322 | 63 | 48 | 22 | 6 | 5 | | | |
| SPSE124508032 | 80 | 50 | 27 | 6 | 6 | | | |
| SPSE124510032 | 100 | 50 | 32 | 6 | 6 | | | |
| SPSE124512540 | 125 | 63 | 40 | 6 | 7 | | | |
| SPSE124516040 | 160 | 63 | 40 | 6 | 8 | | | |

CON REFRIGERAZIONE INTERNA - WITH INTERNAL COOLANT

| CODE | D mm | H mm | d mm | P mm | Z No | Insert | Vite Screw | Torx Key |
|---------------|---------|---------|---------|---------|---------|----------|---------------|-------------|
| SPSE134505022 | 50 | 40 | 22 | 6 | 4 | SE..13T3 | G01 | T15 |
| SPSE134506322 | 63 | 40 | 22 | 6 | 5 | | | |
| SPSE134508027 | 80 | 50 | 27 | 6 | 6 | | | |
| SPSE134510032 | 100 | 50 | 32 | 6 | 6 | | | |
| SPSE134512540 | 125 | 63 | 40 | 6 | 7 | | | |
| SPSE134516040 | 160 | 63 | 40 | 6 | 8 | | | |

CON REFRIGERAZIONE INTERNA - WITH INTERNAL COOLANT

| CODE | D mm | H mm | d mm | P mm | Z No | Insert | Vite Screw | Torx Key |
|---------------|---------|---------|---------|---------|---------|-------------|---------------|-------------|
| SPSN124505022 | 50 | 40 | 22 | 7 | 4 | SNMX1205/06 | H01 | T15 |
| SPSN124506322 | 63 | 40 | 22 | 7 | 6 | | | |
| SPSN124508027 | 80 | 50 | 27 | 7 | 7 | | | |
| SPSN124510032 | 100 | 50 | 32 | 7 | 8 | | | |
| SPSN124512540 | 125 | 63 | 40 | 7 | 10 | | | |

FRESE PER SPIANATURE 45°

Shoulder Milling Cutters 45°

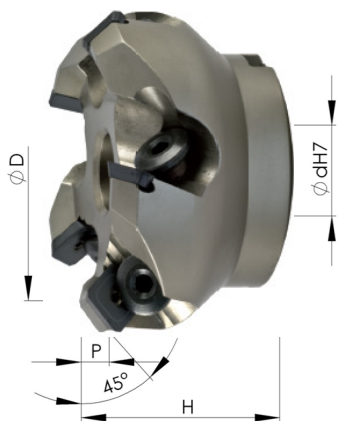

CON REFRIGERAZIONE INTERNA - WITH INTERNAL COOLANT

| CODE | D mm | H mm | d mm | P mm | Z No | Insert | Vite Screw | Hexagonal Key |
|----------------|------|------|------|------|------|-----------|------------|---------------|
| SPSEK124505022 | 50 | 48 | 22 | 6 | 4 | SEK..1203 | L01 | 4mm |
| SPSEK124506322 | 63 | 48 | 22 | 6 | 5 | | | |
| SPSEK124508027 | 80 | 50 | 27 | 6 | 6 | | | |
| SPSEK124510032 | 100 | 50 | 32 | 6 | 6 | | | |
| SPSEK124512540 | 125 | 63 | 40 | 6 | 7 | | | |

FRESE PER SPIANATURE 75°

Shoulder Milling Cutters

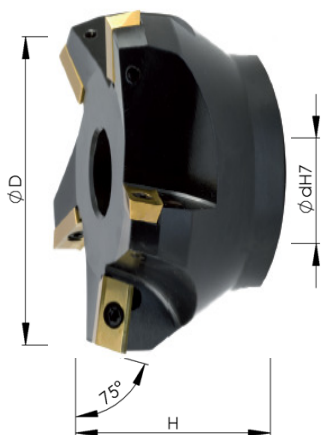

CON REFRIGERAZIONE INTERNA - WITH INTERNAL COOLANT

| CODE | D mm | H mm | d mm | Z No | Insert | Vite Screw | Torx Key |
|---------------|------|------|------|------|----------|------------|----------|
| SPAD157506322 | 63 | 40 | 22 | 4 | ADKT1505 | A49M | T15 |
| SPAD157508027 | 80 | 50 | 27 | 5 | | | |
| SPAD157510032 | 100 | 50 | 32 | 6 | | | |

| CODE | D mm | H mm | d mm | Z No | Insert | Vite Screw | Torx Key |
|---------------|------|------|------|------|----------|------------|----------|
| SPAP167506322 | 63 | 40 | 22 | 4 | AP..1604 | A49M | T15 |
| SPAP167508027 | 80 | 50 | 27 | 5 | | | |
| SPAP167510032 | 100 | 50 | 32 | 6 | | | |

FRESE A RICCIO

Helical End Mills

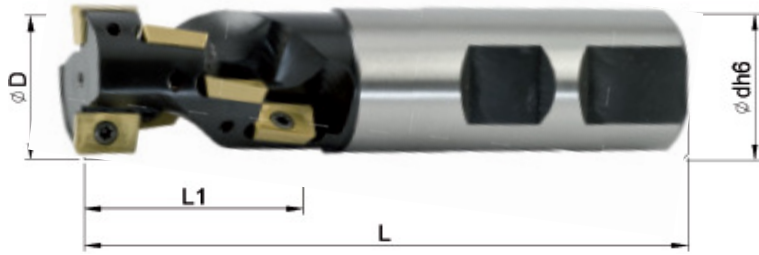

CON REFRIGERAZIONE INTERNA - WITH INTERNAL COOLANT

| CODE | D mm | L1 mm | L mm | d mm | No Inserts | Z No | Insert | Vite Screw | Torx Key |
|---------------|------|-------|------|------|------------|------|----------|------------|----------|
| FAP10R2536100 | 25 | 36 | 100 | 25 | 8 | 2 | AP..1003 | A26M | T08 |
| FAP10R3245120 | 32 | 45 | 120 | 32 | 15 | 3 | | | |

| CODE | D mm | L1 mm | L mm | d mm | No Inserts | Z No | Insert | Vite Screw | Torx Key |
|---------------|------|-------|------|------|------------|------|----------|------------|----------|
| FAP16R3245125 | 32 | 45 | 125 | 32 | 6 | 2 | AP..1604 | A49M | T15 |
| FAP16R4070160 | 40 | 70 | 160 | 40 | 10 | 2 | | | |

FRESE A RICCIO

Helical End Mills

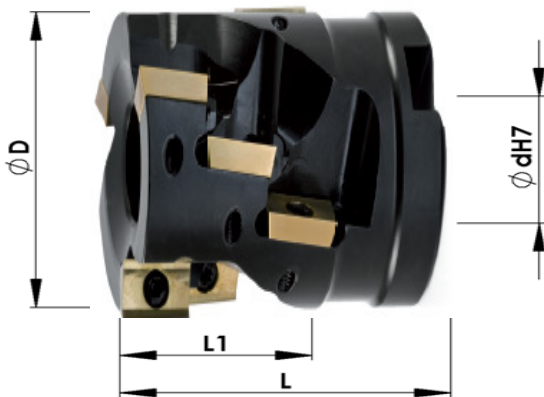

CON REFRIGERAZIONE INTERNA - WITH INTERNAL COOLANT

| CODE | D mm | L1 mm | L mm | d mm | No Inserts | Z No | Insert | Vite Screw | Torx Key |
|---------------|------|-------|------|------|------------|------|----------|------------|----------|
| SPAP16R503004 | 50 | 30 | 55 | 27 | 8 | 4 | AP..1604 | A49M | T15 |
| SPAP16R504403 | 50 | 44 | 70 | 27 | 9 | 3 | | | |
| SPAP16R633004 | 63 | 30 | 55 | 27 | 8 | 4 | | | |
| SPAP16R634404 | 63 | 44 | 60 | 27 | 12 | 4 | | | |
| SPAP16R633005 | 63 | 30 | 55 | 27 | 10 | 5 | | | |
| SPAP16R803004 | 80 | 30 | 55 | 32 | 8 | 4 | | | |
| SPAP16R804405 | 80 | 44 | 60 | 32 | 15 | 5 | | | |

FRESE A RICCIO
Helical End Mills

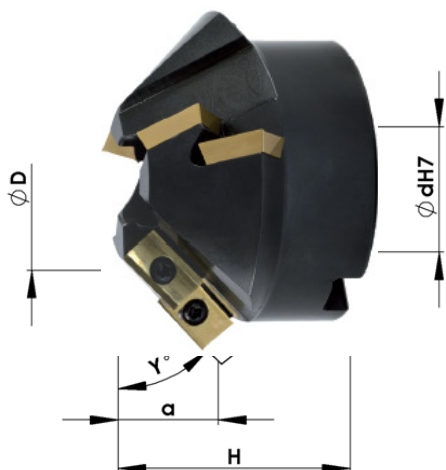

| CODE | D mm | D1 mm | a mm | H mm | d mm | γ° | Z No | Insert | Vite Screw | Torx Key |
|--------------|------|-------|------|------|------|----|------|----------|------------|----------|
| SMAP16359515 | 35 | 95.5 | 7.5 | 50 | 27 | 15 | 3+3 | AP..1604 | A49M | T15 |
| SMAP16358830 | 35 | 88 | 15 | 50 | 27 | 30 | 3+3 | | | |
| SMAP16357845 | 35 | 78 | 21 | 50 | 27 | 45 | 3+3 | | | |
| SMAP16356560 | 35 | 65 | 25.5 | 50 | 27 | 60 | 3+3 | | | |
| SMAP16355075 | 35 | 50.5 | 29 | 60 | 32 | 75 | 3+3 | | | |

FRESE PER SMUSSI E SVASATURE
Chamfering Milling cutter

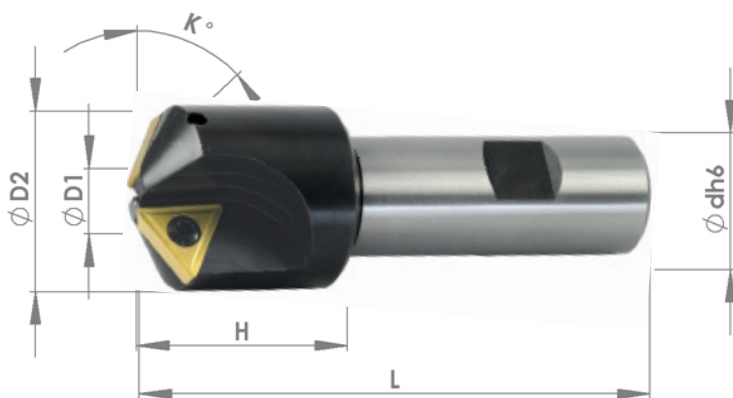

| CODE | D1 mm | D2 mm | H mm | L mm | d mm | κ° | Z No | Insert | Vite Screw | Torx Key |
|----------------|-------|-------|------|------|------|----|------|-----------|------------|----------|
| SMTC1630603295 | 6 | 32 | 39 | 95 | 20 | 30 | 2 | TC..16T3 | A49M | T15 |
| SMTC1645181570 | 1.8 | 15.5 | 20 | 70 | 12 | 45 | 1 | TC..1102 | A25M | T07 |
| SMTC1645061990 | 6 | 19.5 | 35 | 90 | 20 | 45 | 2 | | | |
| SMTC1645002095 | 0 | 20 | 45 | 95 | 20 | 45 | 1 | TCMX 16T3 | A49M | T15 |
| SMTC1645123295 | 12.5 | 32.5 | 39 | 95 | 25 | 45 | 2 | TC..16T3 | | |
| SMTC1660541670 | 5.4 | 16 | 20 | 70 | 12 | 60 | 1 | TC..1102 | A25M | T07 |
| SMTC1660162690 | 15.8 | 26 | 35 | 90 | 20 | 60 | 2 | | | |
| SMTC1660203595 | 20 | 35 | 39 | 95 | 25 | 60 | 2 | TC..16T3 | A49M | T15 |

FRESE PER SMUSSI E SVASATURE

Chamfering Milling cutter

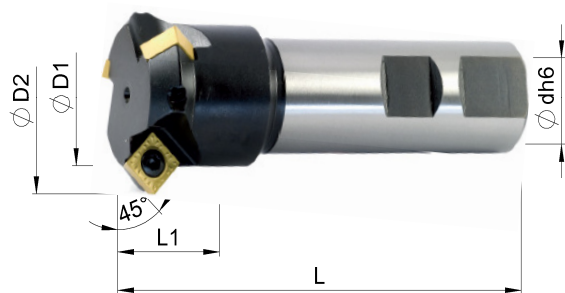

| CODE | D1 mm | D2 mm | L1 mm | L mm | d mm | Z No | Insert | Vite Screw | Torx Key |
|-----------------|-------|-------|-------|------|------|------|----------|------------|----------|
| SMSC09451223100 | 12 | 23.7 | 25 | 100 | 20 | 1 | SC..09T3 | A49M | T15 |
| SMSC09451628100 | 16 | 28.8 | 35 | 100 | 20 | 2 | | | |
| SMSC09453042100 | 30 | 42.3 | 35 | 100 | 25 | 3 | | | |
| SMSC09451223200 | 12 | 23.7 | 25 | 200 | 20 | 1 | | | |
| SMSC09451628200 | 16 | 28.8 | 42 | 200 | 20 | 2 | | | |
| SMSC09453042200 | 30 | 42.3 | 40 | 200 | 25 | 3 | | | |

FRESE PER LAMATURE

Spot Facing Milling Cutters



CON REFRIGERAZIONE INTERNA - WITH INTERNAL COOLANT

| CODE | D mm | a mm | L1 mm | L mm | d mm | Z No | Insert | Vite Screw | Torx Key |
|-----------------|------|------|-------|------|------|------|----------|------------|----------|
| LMCC06150530085 | 15 | 5 | 30 | 85 | 12 | 1 | CC..0602 | A25M | T07 |
| LMCC06160530092 | 16 | 5 | 30 | 92 | 12 | 2 | | | |
| LMCC06170632094 | 17 | 6 | 32 | 94 | 16 | 2 | | | |
| LMCC06170640096 | 17.5 | 6.5 | 40 | 96 | 16 | 2 | | | |
| LMCC06180741097 | 18 | 7 | 41 | 97 | 16 | 2 | | | |
| LMCC06190841100 | 19 | 8 | 41 | 100 | 16 | 2 | | | |
| LMCC06200941102 | 20 | 9 | 41 | 102 | 16 | 2 | | | |
| LMCC06211041105 | 21 | 10 | 41 | 105 | 16 | 2 | | | |
| LMCC06221141110 | 22 | 11 | 41 | 110 | 16 | 2 | | | |
| LMCC06231241112 | 23 | 12 | 41 | 112 | 16 | 2 | | | |
| LMCC06241341115 | 24 | 13 | 41 | 115 | 16 | 2 | | | |
| LMCC06250840120 | 25 | 8 | 40 | 120 | 16 | 2 | CC..09T3 | A48M | T15 |
| LMCC06260955125 | 26 | 9 | 55 | 125 | 20 | 2 | | | |
| LMCC06271055128 | 27 | 10 | 55 | 128 | 20 | 2 | | | |
| LMCC06281155130 | 28 | 11 | 55 | 130 | 20 | 2 | | | |
| LMCC06291255132 | 29 | 12 | 55 | 132 | 20 | 2 | | | |
| LMCC06301355134 | 30 | 13 | 55 | 134 | 20 | 2 | | | |
| LMCC06311455136 | 31 | 14 | 55 | 136 | 20 | 2 | | | |
| LMCC06321555138 | 32 | 15 | 55 | 138 | 20 | 2 | | | |
| LMCC06331655140 | 33 | 16 | 55 | 140 | 20 | 2 | | | |
| LMCC06341660140 | 34 | 16 | 60 | 140 | 25 | 2 | | | |
| LMCC06351760140 | 35 | 17 | 60 | 140 | 25 | 2 | | | |
| LMCC06382060140 | 38 | 20 | 60 | 140 | 25 | 2 | CC..09T3 | A49M | |
| LMCC06422460140 | 42 | 24 | 60 | 140 | 25 | 2 | | | |

FRESE PER LAMATURE
Spot Facing Milling Cutters



CON REFRIGERAZIONE INTERNA - WITH INTERNAL COOLANT

| CODE | D mm | L1 mm | L mm | d mm | Z No | Insert | Vite Screw | Torx Key |
|---------------|---------|----------|---------|---------|---------|----------|---------------|-------------|
| ALCC061023090 | 9.8 | 23 | 90 | 8 | 1 | CC..0602 | A25M | T07 |
| ALCC061124105 | 10.8 | 24 | 105 | 10 | 1 | | | |
| ALCC061225105 | 11.8 | 25 | 105 | 10 | 1 | | | |
| ALCC061325105 | 12.8 | 26 | 105 | 10 | 1 | | | |
| ALCC061427110 | 13.8 | 27 | 110 | 12 | 1 | | | |
| ALCC061528120 | 14.8 | 28 | 120 | 12 | 1 | | | |
| ALCC061629125 | 15.8 | 29 | 125 | 12 | 1 | | | |
| ALCC061730140 | 16.8 | 30 | 140 | 16 | 1 | | | |
| ALCC061831140 | 17.8 | 31 | 140 | 16 | 1 | | | |
| ALCC061931150 | 18.8 | 32 | 150 | 16 | 1 | | | |
| ALCC062033150 | 19.8 | 33 | 150 | 16 | 1 | | | |
| ALCC062134150 | 20.8 | 34 | 160 | 20 | 1 | CC..09T3 | A48M | T15 |
| ALCC062235160 | 21.8 | 35 | 160 | 20 | 1 | | | |
| ALCC062336165 | 22.8 | 36 | 165 | 20 | 1 | | | |
| ALCC062437170 | 23.8 | 37 | 170 | 20 | 1 | | | |
| ALCC062538180 | 24.8 | 38 | 180 | 20 | 1 | | | |
| ALCC062639185 | 25.8 | 39 | 185 | 20 | 1 | | | |
| ALCC062740190 | 26.8 | 40 | 190 | 20 | 1 | | | |
| ALCC062840190 | 27.8 | 41 | 190 | 20 | 1 | | | |
| ALCC062943200 | 28.8 | 42 | 200 | 20 | 1 | | | |
| ALCC063043200 | 29.8 | 43 | 200 | 25 | 1 | | | |
| ALCC063144200 | 30.8 | 44 | 200 | 25 | 1 | | | |
| ALCC063245200 | 31.8 | 45 | 200 | 25 | 1 | | | |

LAME PER TAGLIO E GOLA

Blades for Parting-Off

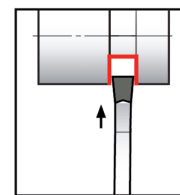
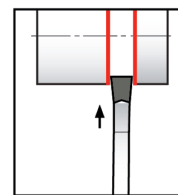
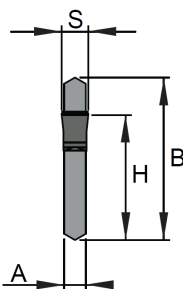
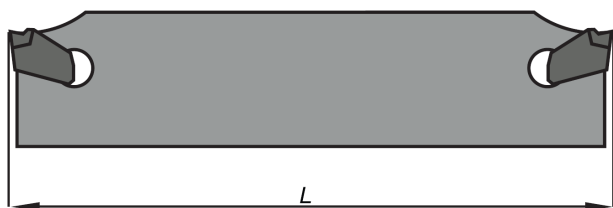

| CODE | B mm | S mm | H mm | A mm | L mm | Insert | Chiave Key |
|-------------|------|------|------|------|------|----------|------------|
| LAMVRST19-1 | 19 | 2 | 16 | 1.6 | 85 | VRST-101 | 5mm |
| LAMVRST26-1 | 26 | 2 | 21.4 | 1.6 | 110 | | |
| LAMVRST26-2 | 26 | 3 | 21.4 | 2.4 | 110 | | |
| LAMVRST26-3 | 26 | 4 | 21.4 | 3.2 | 110 | | |
| LAMVRST26-4 | 26 | 5 | 21.4 | 4 | 110 | | |
| LAMVRST26-5 | 26 | 6 | 21.4 | 5.2 | 110 | VRST-105 | |
| LAMVRST32-1 | 32 | 2 | 26 | 1.6 | 150 | VRST-101 | |
| LAMVRST32-2 | 32 | 3 | 26 | 2.4 | 150 | VRST-102 | |
| LAMVRST32-3 | 32 | 4 | 26 | 3.2 | 150 | VRST-103 | |
| LAMVRST32-4 | 32 | 5 | 26 | 4 | 150 | VRST-104 | |
| LAMVRST32-5 | 32 | 6 | 26 | 5.2 | 150 | VRST-105 | |

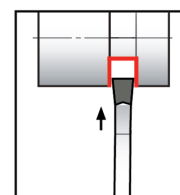
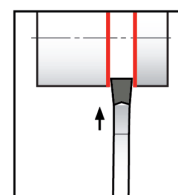
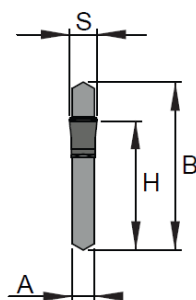

| CODE | B mm | S mm | H mm | A mm | L mm | Insert | Chiave Key |
|-------------|------|------|------|------|------|----------|------------|
| LAMVRSU32-1 | 32 | 3 | 25 | 2.4 | 150 | VRSU-101 | 5mm |
| LAMVRSU32-2 | 32 | 4 | 25 | 3.2 | 150 | VRSU-102 | |
| LAMVRSU32-3 | 32 | 5 | 25 | 4 | 150 | VRSU-103 | |



Nuova C.U.M.E.T. Srl - Via Torino, 502
10032 Brandizzo (TO) ITALY
Tel: +39 011 917 95 14/15
Telefax: +39 011 917 95 55/02
www.nuovacumet.it • info@nuovacumet.it

B.A. Machinery
Beijing
Tel: (86)-10-63777466/76
Telefax: (86)-10-63777486
www.nuovacumet.cn • info@nuovacumet.cn

CUMET Tools s.r.o.
Vilová 298/1746010 - Liberec 10
Czech Republic
GSM +420-602 232 383
www.cumet.cz • zuda@cumet.cz